

# EX133 BEAMS

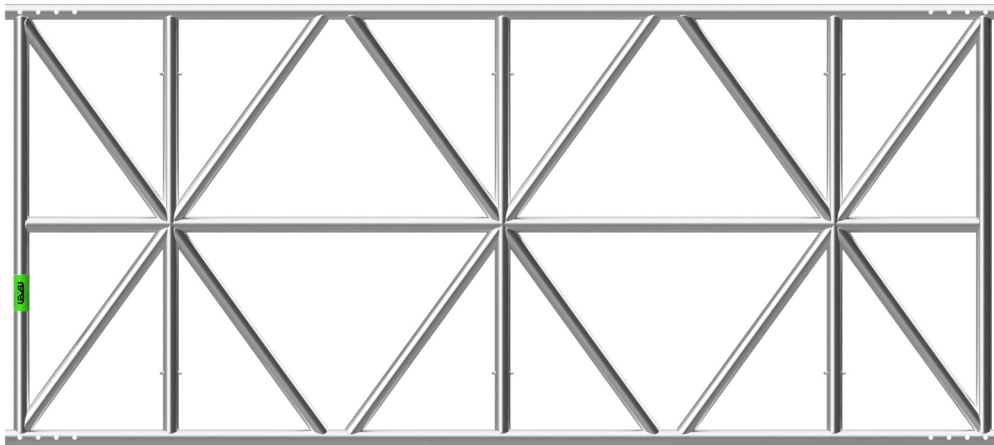

## SUPER HEAVY DUTY ALUMINIUM BEAM



### FEATURES

Available in 0.5, 1.0, 2.0, 3.0, and 4.0m lengths

8 & 36 degree ridges to form pitched roof

Wall & floor brackets to suit

48.3mm scaffold tube sized top & bottom chords, vertical and diagonal posts

Design registered, unique locating pin for system brace retention to top & bottom of posts

Flat pack beam alignment for stacking & transportation

### WHY CHOOSE EX133?

Super high strength to weight ratio

Suitable for use with standard scaffold couplers

Suitable for use with traditional Tube & Fitting and any System Scaffold

System brace compatible

User friendly in terms of manual handling and working directly from **height** [can be straddled in conjunction with the use of twin lanyard]

### USE FOR:

- Very large beam spans
- Temporary buildings & shelters
- Large/ very heavy duty bridging
- Large span temporary roofs

- Vertical screens
- Heavy duty cantilever support
- Staging & lighting
- Mobile structures

# PRODUCT SPECIFICATION

## EX133

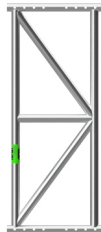

PART	EX133_0500
DESCRIPTION	EX133 aluminium beam 0.5m
WEIGHT [KG]	4.7

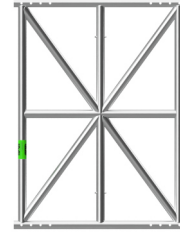

PART	EX133_1000
DESCRIPTION	EX133 aluminium beam 1.0m
WEIGHT [KG]	13.8

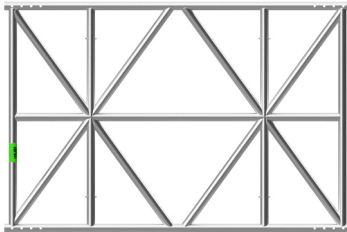

PART	EX133_2000
DESCRIPTION	EX133 aluminium beam 2.0m
WEIGHT [KG]	23.6

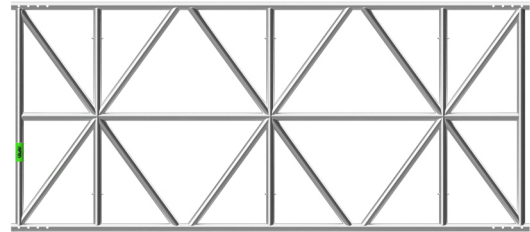

PART	EX133_3000
DESCRIPTION	EX133 aluminium beam 3.0m
WEIGHT [KG]	33.1

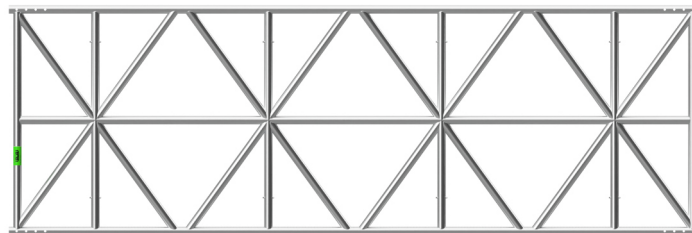

PART	EX133_4000
DESCRIPTION	EX133 aluminium beam 4.0m
WEIGHT [KG]	42.8



PART NO.	EVQR12_60
DIMENSIONS	OD12 x 60
DESCRIPTION	Spring pin
WEIGHT [KG]	0.08



PART NO.	BS0008H
DIMENSIONS	OD38.1 x 496
HOLES REQ.	4 per side
DESCRIPTION	8 hole joining spigot
WEIGHT [KG]	1.3