

# EV45 BEAMS

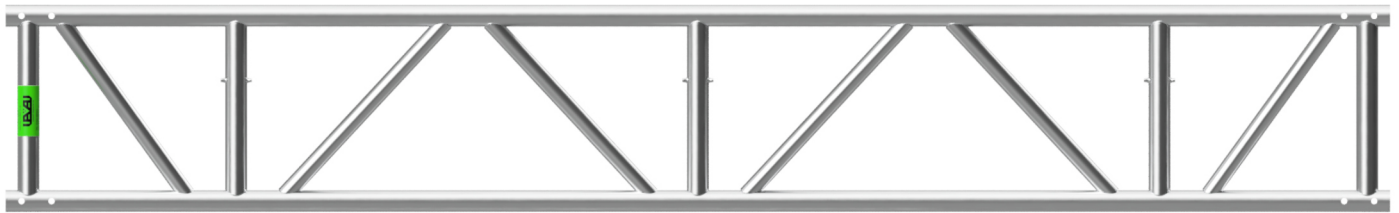

LIGHTWEIGHT.  
MEDIUM DUTY ALUMINIUM



## FEATURES

Available in 0.5, 1.0, 2.0, 3.0, 4.0, 5.0 and 6.0m lengths

18 & 36 degree ridges to form pitched roof

Wall & floor brackets to suit

48.3mm scaffold tube sized top & bottom chords & vertical posts

Design registered, unique locating pin for system brace retention

Flat pack beam alignment for stack

## WHY CHOOSE EV45?

High strength to weight ratio

Strongest 45cm beam in the market

Suitable for use with standard scaffold couplers

Suitable for use with traditional Tube & Fitting, and any System Scaffold

## USE

- Typical beam spans
- Bridging
- Temporary roofs
- Vertical screens
- Self bracing tension chord (end attachment required)
- Suspended platforms
- Cantilever support
- Staging and lighting
- Temporary buildings & shelters

# PRODUCT SPECIFICATION



PART	EV045_0500
DESCRIPTION	EV45 aluminium beam 0.5m
WEIGHT [KG]	3.0



PART	EV045_1000
DESCRIPTION	EV45 aluminium beam 1.0m
WEIGHT [KG]	6.0



PART	EV045_2000
DESCRIPTION	EV45 aluminium beam 2.0m
WEIGHT [KG]	12.0



PART	EV045_3000
DESCRIPTION	EV45 aluminium beam 3.0m
WEIGHT [KG]	17.5



PART	EV045_4000
DESCRIPTION	EV45 aluminium beam 4.0m
WEIGHT [KG]	22.0



PART	EV045_5000
DESCRIPTION	EV45 aluminium beam 5.0m
WEIGHT [KG]	26.0



PART	EV045_6000
DESCRIPTION	EV45 aluminium beam 6.0m
WEIGHT [KG]	34.5



PART NO.	EVQR12_60
DIMENSIONS	OD12 x 60
DESCRIPTION	Spring pin
WEIGHT [KG]	0.08



PART NO.	EVBS006
DIMENSIONS	OD38.1 x 496
HOLES REQ.	3 per side
DESCRIPTION	6 hole joining spigot
WEIGHT [KG]	1.2